

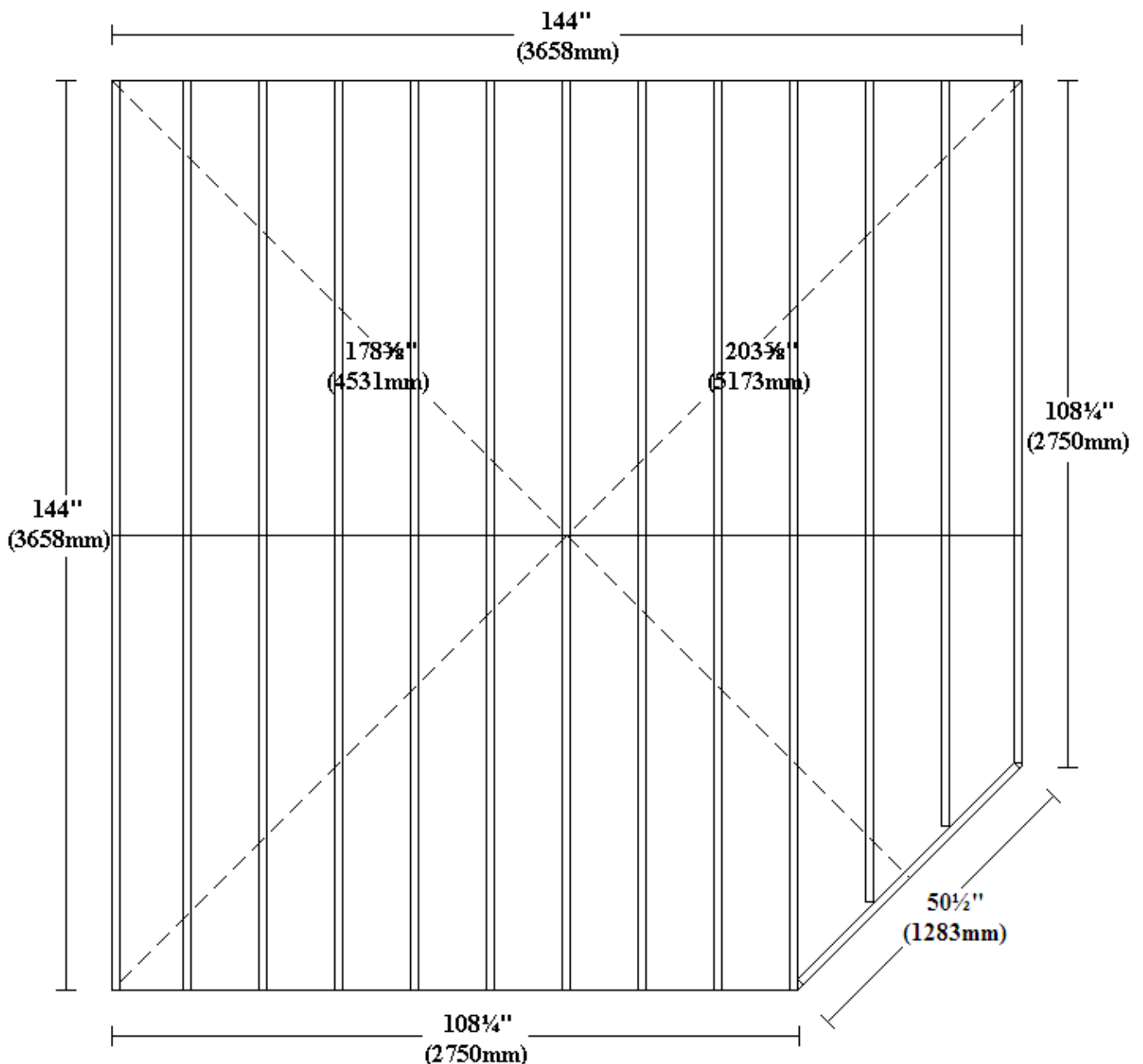

**IMPORTANT:** Please note that the Clifton requires a patio slab, concrete or timber decking foundation. It is essential that the base is completely level in all directions, otherwise windows and doors may not operate correctly. A minimum clearance of 18" (456mm) must be available ALL around the building for installation purposes.

### 3.66m x 3.66m (12' x 12') Clifton



NB:- Floor joists run from right hand back to left hand front.